

**MONUMENT RECORD**  
**State of Indiana - County of Monroe**

**Section: 05**

**Township: 8 North**

**Range: 1 East**

**Corner ID: Sa Cr G-03**

**Monument Description & Remarks:** Found 5/8" Rebar with cap marked "Bledsoe Tapp PE 50920004" at center of section. Metal fence post 5" to the east; stream approximately 25' SE.

**References on file in the County Surveyor's Office:** Bledsoe Tapp survey recorded in Book 4, Page 129 in the Recorder's Office; Graham survey dated 4-1-97 (parcel off Lampkins Ridge Road).

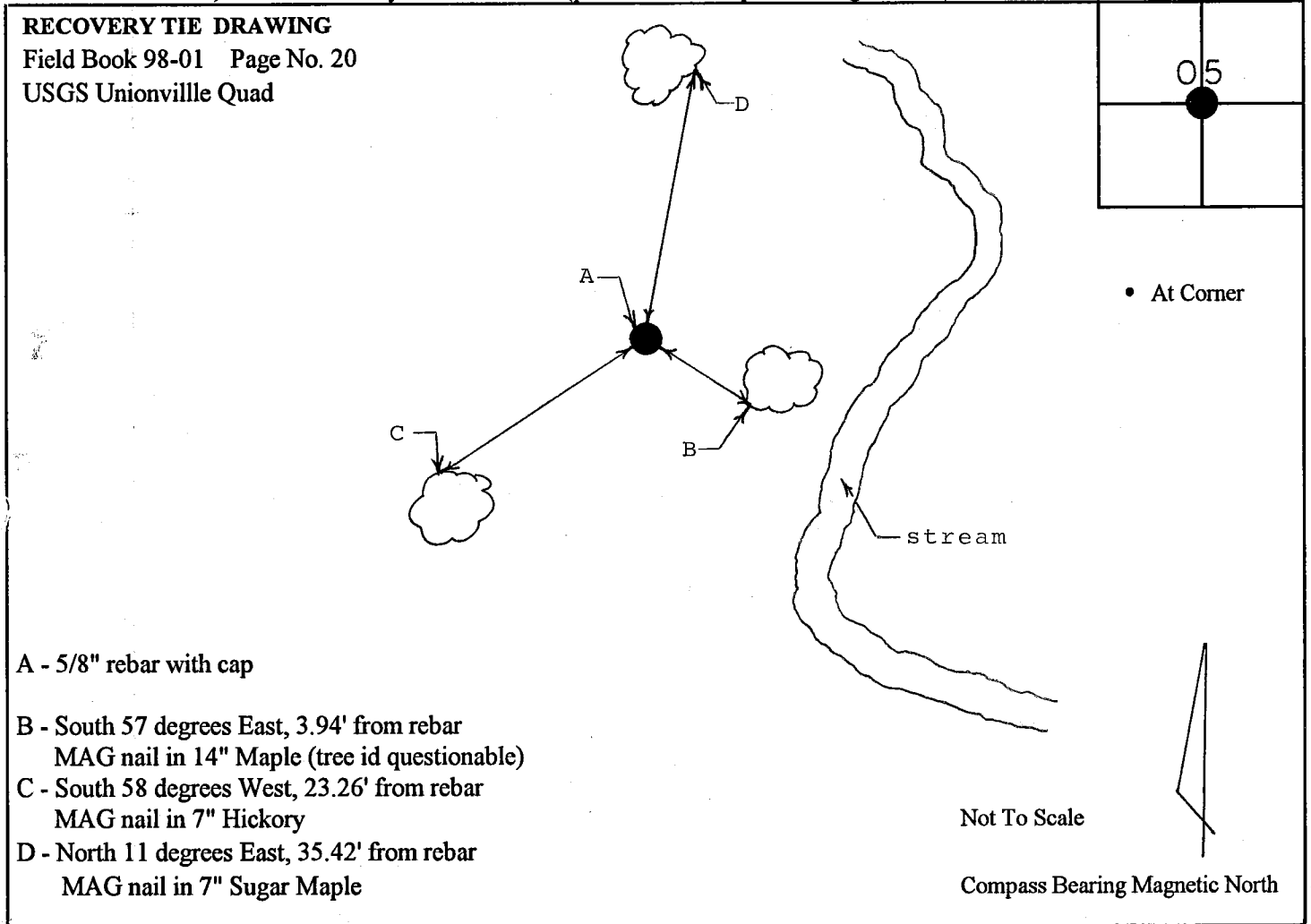

I, Kevin P. Enright, Monroe County Surveyor, hereby certify that this document was prepared under my direction in accordance with the provisions of Section 36-2-12-11 of the Indiana Code, and the above data is given under my hand and seal this 9th day of January, 1998.

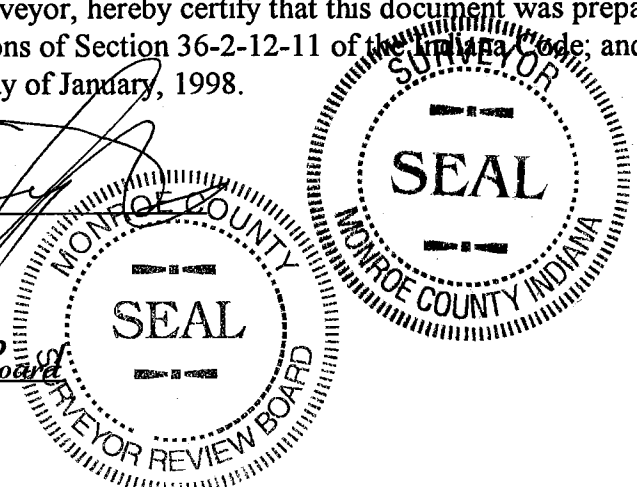

Administered by: *Surveyor Review Board*